

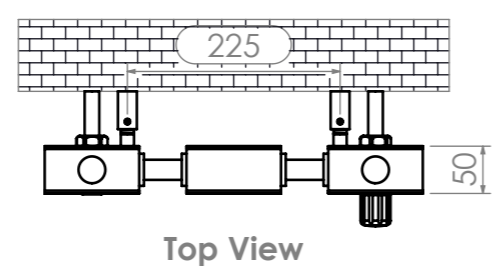

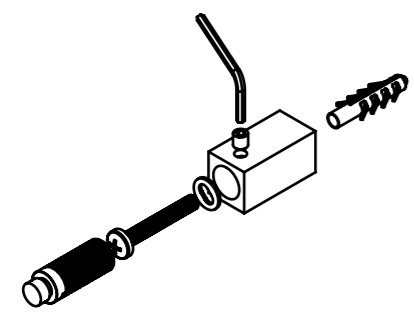

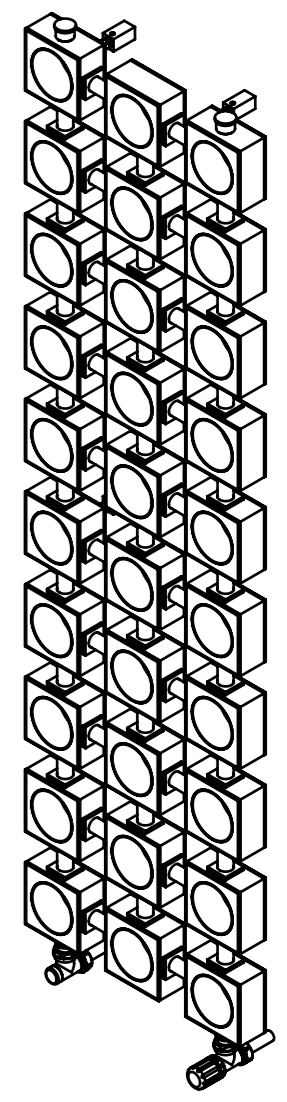

# Lokum 30

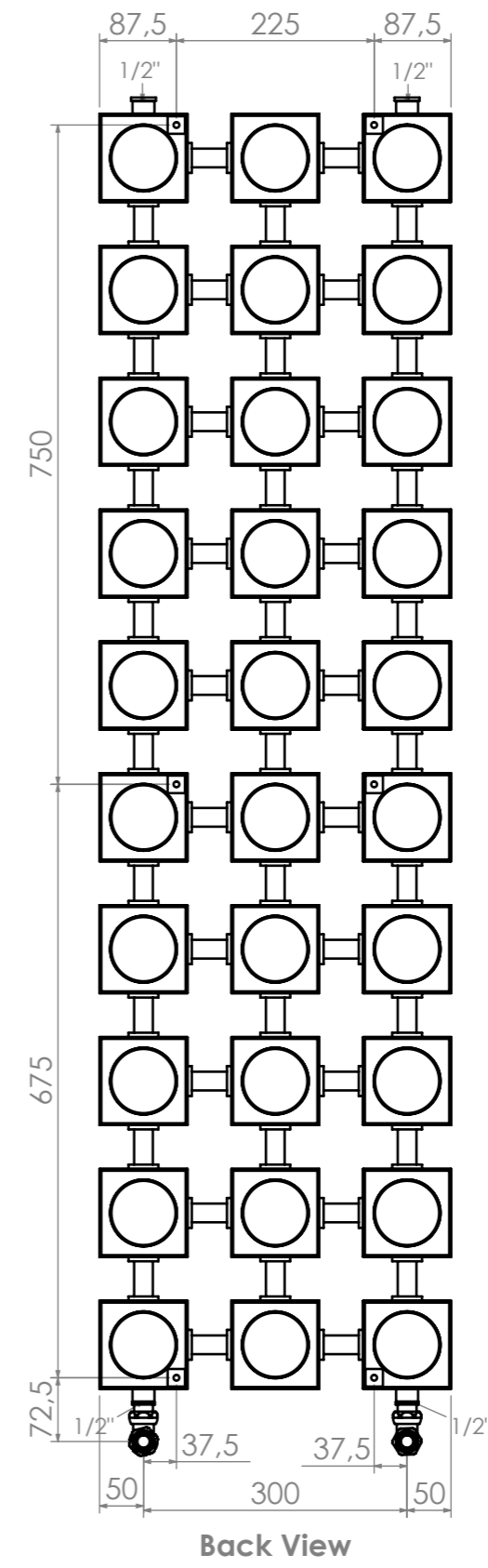
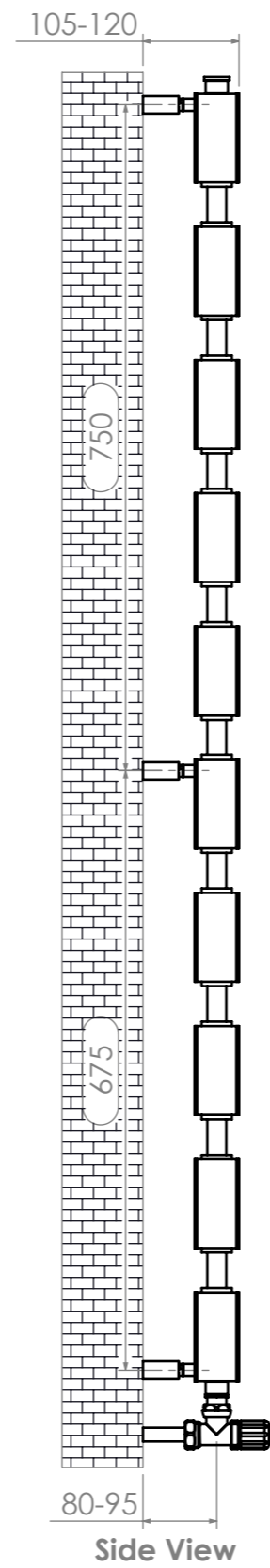
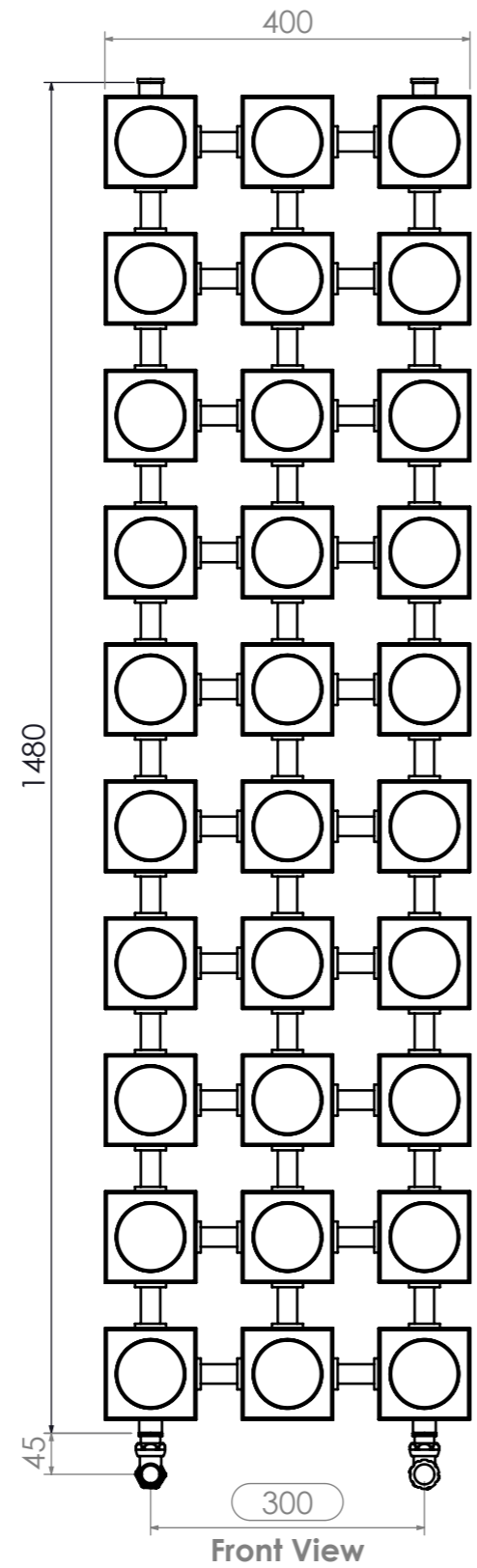

## Installation Accessories:

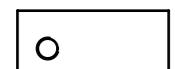
-  x6
-  x6
-  x6
-  x6
-  x6
-  x6
-  x6
-  x1

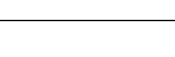
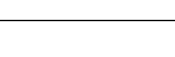
## Plumbing Position:

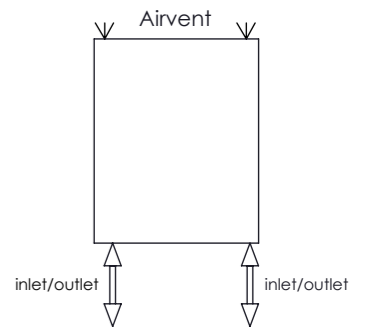

All Dimensions are in mm  
 Max. Working Pressure: 10 Bar  
 Max. Working Temperature: 95° C  
 Inlet / Outlet : 1/2" BSP  
 Fuel : H