

# Mystic E614-Rev01

REVISIONS				
ZONE	REV.	DESCRIPTION	DATE	APPROVED
	00	İlk Yayın Tarihi	01-01-2011	
	01	Tarak Modeli Değişti.	21.05.2021	H.KÖROĞLU

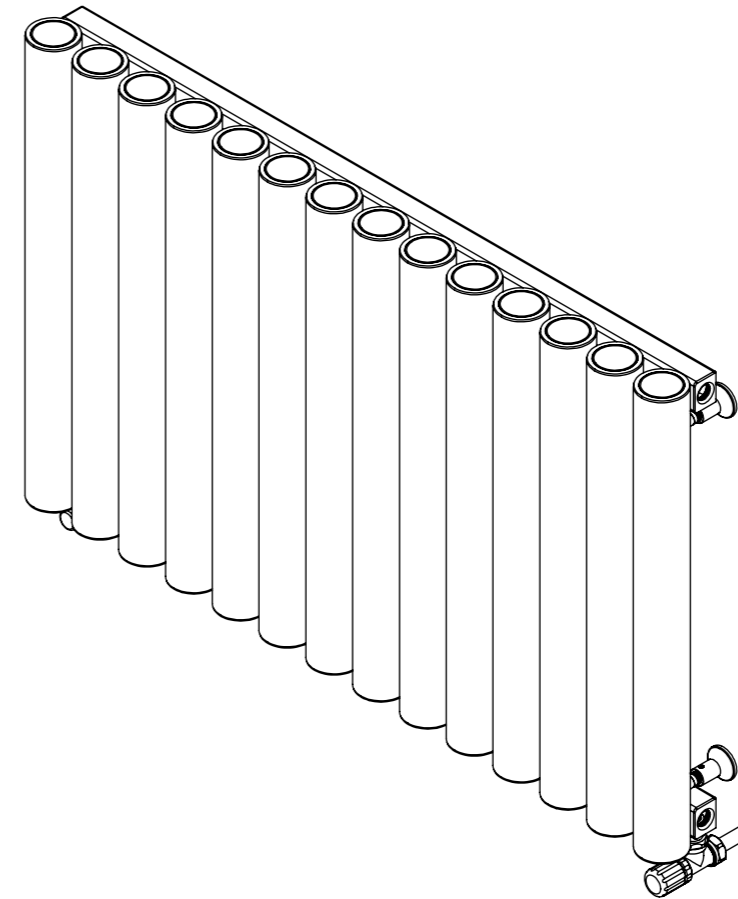

## Installation Accesories:

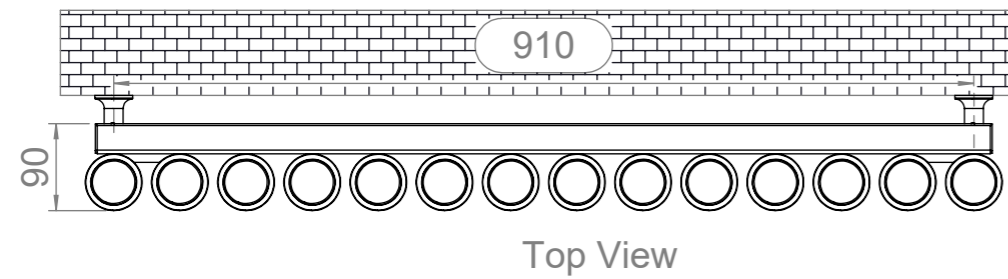
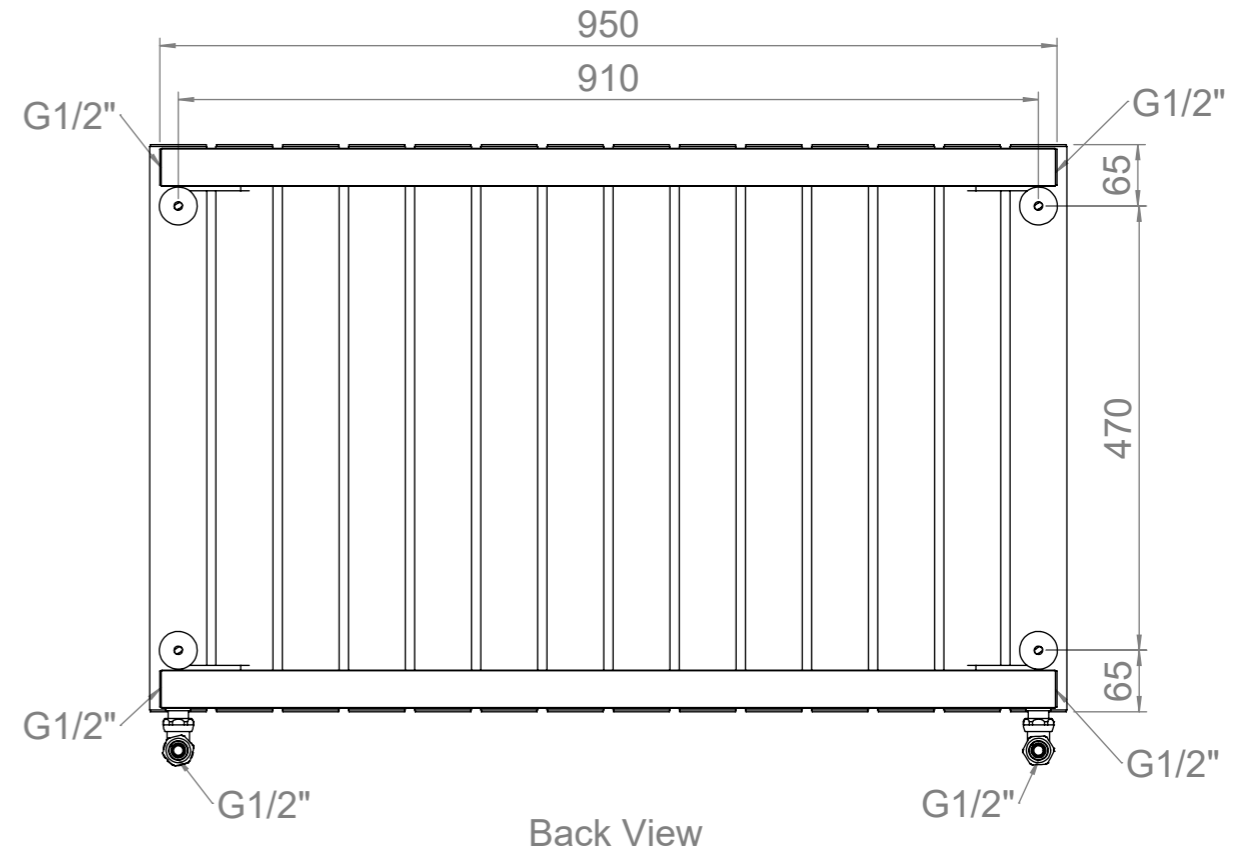
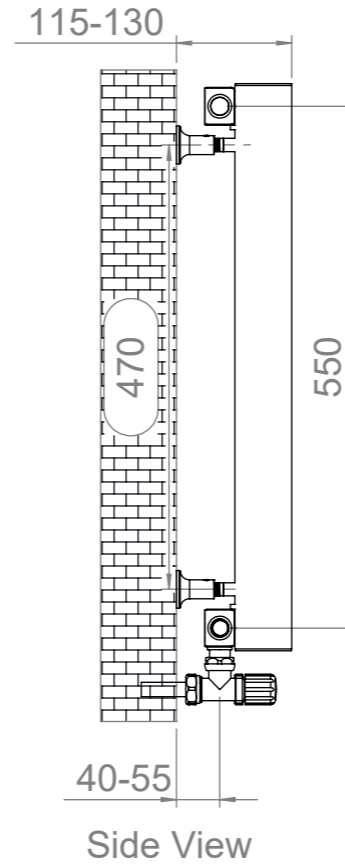
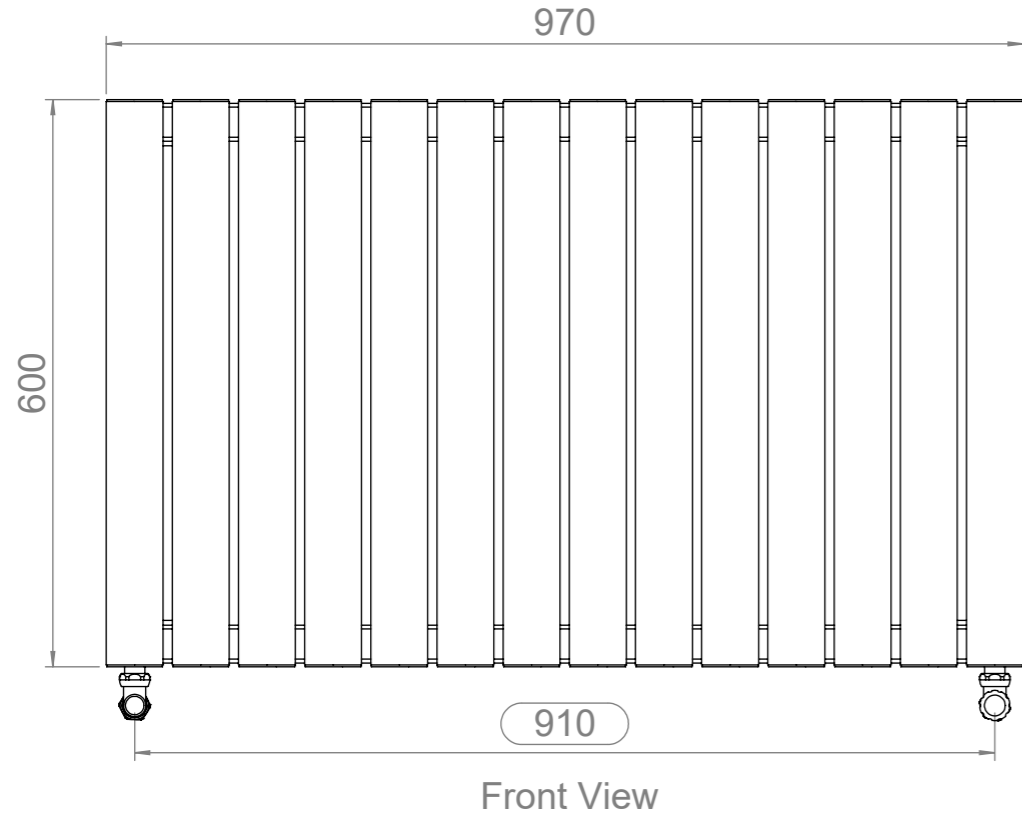
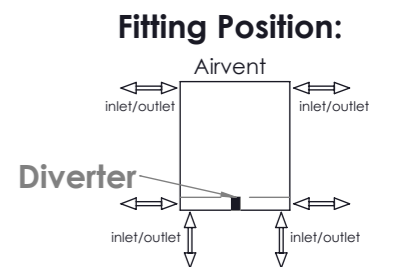
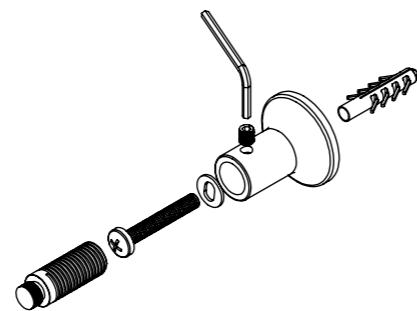
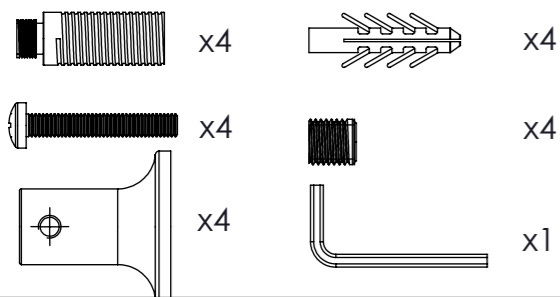

All Dimension are in mm  
 Max.Working Pressure = 10 Bar  
 Max.Working Temperature=95° C  
 Inlet / Outlet : 1/2" BSP